



Lower Priory Street
Semilong, Northampton

oriordanbond
SALES & LETTINGS



Lower Priory Street

Semilong
NN1 2PA

Price
£215,000

A refurbished modern three/four bedroom terraced property located in the popular area of Semilong in Northampton. The property is within walking distance of Northampton train station, Northampton International Academy and plenty of shops. The property is offered to market with no onward chain and is ideal as a buy-to-let purchase or first time buyers.

Accommodation comprises, entrance hall, brand new kitchen/dining/living room with wood flooring and access to the rear garden, fully tiled three-piece family bathroom, converted cellar with heating which is ideal as an office or fourth bedroom and three double bedrooms to the first floor. Outside is a low maintenance rear garden with artificial lawn. Further benefits include uPVC double glazing and new gas radiator heating. (A/742/S)

- Refurbished three/four bedroom property
- Brand new kitchen/dining/living room
- Converted cellar for use as office or bedroom
- New gas radiator heating
- Low maintenance rear garden
- No onward chain

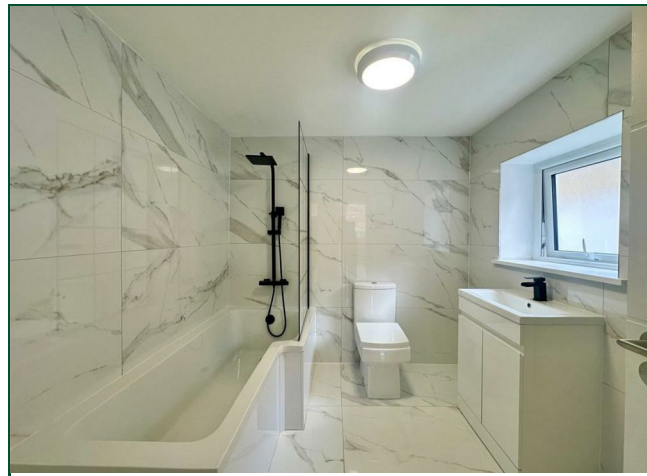





Additional information

- Council Tax Band: A
- Energy Efficiency Rating: C

Viewing

Viewing strictly by appointment – details below

Disclaimer

O’Riordan Bond Estate Agents Limited has not tested apparatus, equipment, fittings or services and so cannot verify they are in working order. The buyer is advised to obtain verification from their solicitor or surveyor.

O’Riordan Bond Kingsthorpe Sales

01604 722007

kingsthorpe@oriordanbond.co.uk



BASEMENT
111 sq.ft. (10.3 sq.m.) approx.

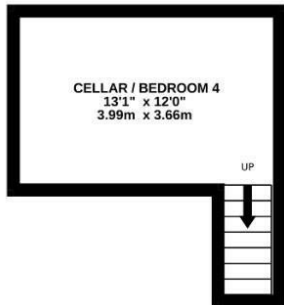

GROUND FLOOR
315 sq.ft. (29.3 sq.m.) approx.

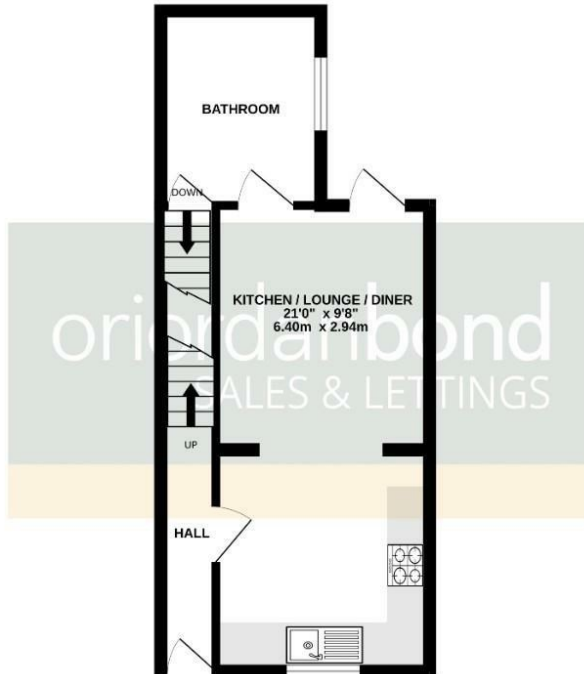

1ST FLOOR
316 sq.ft. (29.4 sq.m.) approx.



TOTAL FLOOR AREA : 742 sq.ft. (69.0 sq.m.) approx.

Whilst every attempt has been made to ensure the accuracy of the floorplan contained here, measurements of doors, windows, rooms and any other items are approximate and no responsibility is taken for any error, omission or mis-statement. This plan is for illustrative purposes only and should be used as such by any prospective purchaser. The services, systems and appliances shown have not been tested and no guarantee as to their operability or efficiency can be given.
Made with Metropix ©2026